

**PERMIT APPLICATION
for Part 91
SOIL EROSION AND
SEDIMENTATION CONTROL**

OFFICE USE ONLY

Permit Number
Date Issued
Expiration Date
File Number

1. APPLICANT (Please check if applicant is the landowner or designated agent*)

Name	Landowner	Designated Agent
Address		
City	State	Zip Code
Area Code/Telephone Number		

2. LOCATION

Section	Town	Range	Township	City/Village	County
Subdivision	Lot No.	Tax ID Number	Street Address		

3. PROPOSED EARTH CHANGE

Project Type:	Residential	Multi-family	Commercial
	Industrial	Land Balancing	
Describe Project			Size of Earth Change (acres or square feet)
Name of and Distance to Nearest Lake, Stream, or Drain		Date Project to Start	Date Project to be Completed

4. SOIL EROSION AND SEDIMENTATION CONTROL PLAN (Refer to Rule 323.1703)

Note: _____ complete sets of plans must be attached.	Estimated Cost of Erosion and Sediment Control
	Plan Preparer's Name and Telephone Number Area Code ()

5. PARTIES RESPONSIBLE FOR EARTH CHANGE

Name of Landowner (if not provided in Box No. 1 above)	Address		
City	State	Zip	Area Code/Telephone Number
Name of Individual "On Site" Responsible for Earth Change		Company Name	
Address	City	State	Zip Code
		Area Code/Telephone Number	

6. PERFORMANCE DEPOSIT (If required by the permitting agency)

Amount Required \$ _____	Cash	Certified Check	Irrevocable Letter of Credit	Surety Bond
Name of Surety Company				
Address	City	State	Zip Code	Area Code/Telephone No.

I (we) affirm that the above information is accurate and that I (we) will conduct the above described earth change in accordance with Part 91, Soil Erosion and Sedimentation Control, of the Natural Resources and Environmental Protection Act, 1994 PA 451, as amended, applicable local ordinances, and the documents accompanying this application.

Landowner's Signature	Print Name	Date
Designated Agent's Signature*	Print Name	Date

* Designated agent must have a written statement from landowner authorizing him/her to secure a permit in the landowner's name.



**300 N. Mill Street
Saint Louis, Michigan 48880-1529
Telephone: (989) 681-2137
Fax: (989) 681-3842**

Date

I authorize _____ to act as my representative in
regard to Soil Erosion and Sedimentation Control at my property located
at _____. In doing so, I agree
to the Specified requirements on the Soil Erosion and Sedimentation Control permit.

Signature

Phone # of Property Owner

City Of St. Louis
Soil Erosion and Sedimentation Permit Fees with Inspections

<u>APPLICATION FEE</u>	One & Two Family/Small Add./Garage/Mobile Hm. Pads	\$20.00
<u>TRANSPORTATION FACILITIES</u>	Up to ½ mile	\$100.00
Streets, highways, roadways	Each add. ½ mile or fraction	\$35.00
<u>SUBDIVISION</u>	Base Fee	\$50.00
Plat development, Mobile home parks & multiple housing units	Per Lot	\$10.00
<u>INDUSTRIAL & COMMERCIAL DEVELOPMENT</u>	Up to 1 acre	\$50.00
	Each add. Acre	\$50.00
<u>SERVICE FACILITIES</u>	Up to 1 acre	\$50.00
Schools, Churches, Shopping centers	Each add. Acre	\$50.00
<u>UTILITIES</u>	Up to ½ mile	\$100.00
Underground Distribution/ Transmission, Pipelines, Underground Cables	Each add. ½ mile	\$35.00
<u>SINGLE OR TWO-FAMILY RESIDENTIAL</u>		\$50.00
<u>WATER IMPOUNDMENTS, WATERWAYS, OR GENERAL GRADING IMPROVEMNETS</u>		
Water impoundment, Land balancing, or other	Up to 1 acre	\$60.00
General earth change activities	Each add. 1 Acre	\$15.00
<u>SEAWALLS</u>	Up to 200 feet	\$50.00
	Each add. 100 feet	\$25.00
<u>ADDITIONAL INSPECTIONS</u>		
Requested by permit holder or Inspections subsequence to a Violation notice	Per inspection	\$25.00
<u>REQUESTED SITE EVALUATION</u>		
Prior to the granting of a permit	Up to 2 hours	\$45.00
	Each add. 1 hour	\$25.00

300 N. Mill St., St. Louis, MI 48880
(989) 681-4621

Adopted by City Council
February 18, 2003

Soil Erosion and Sedimentation Control

13 Items required on a SESC Plan pursuant to Rule 1702

All 13 Items Must be Listed on SESC Plan, Permit Will Not Be Issued If They Are Not.

1. Scaled Map
2. Site Location
3. Proximity to lakes/streams
4. Limits of Earth Change
5. Predominant land features
6. Slope information
7. Soils information
8. On-site drainage and dewatering facilities
9. Timing and sequencing
10. Schedule
11. Temporary SESC measures, permanent SESC measures
12. Maintenance program for permanent SESC measures
13. Legal Description of Property

EROSION CONTROL PLAN LEGEND

(use key below to place needed objects on the plan, use a scale or ruler to draw home location and locate any other trees or buildings on your property. Please label roads. You only need to show the area that will be disturbed and the access drive.)

Property Line - - - - -

Existing Drainage - - - - -

Temp. Diversion - - - - -

Finished Drainage - - - - -

Limits of Grading - - - - -

Silt Fence - S - S -

Show stone access drive, tree preservation and temporary soil stockpile.

DRAFT

Owner: James Smith
Telephone:(989)555-5555

Scale 1 inch = _____ feet

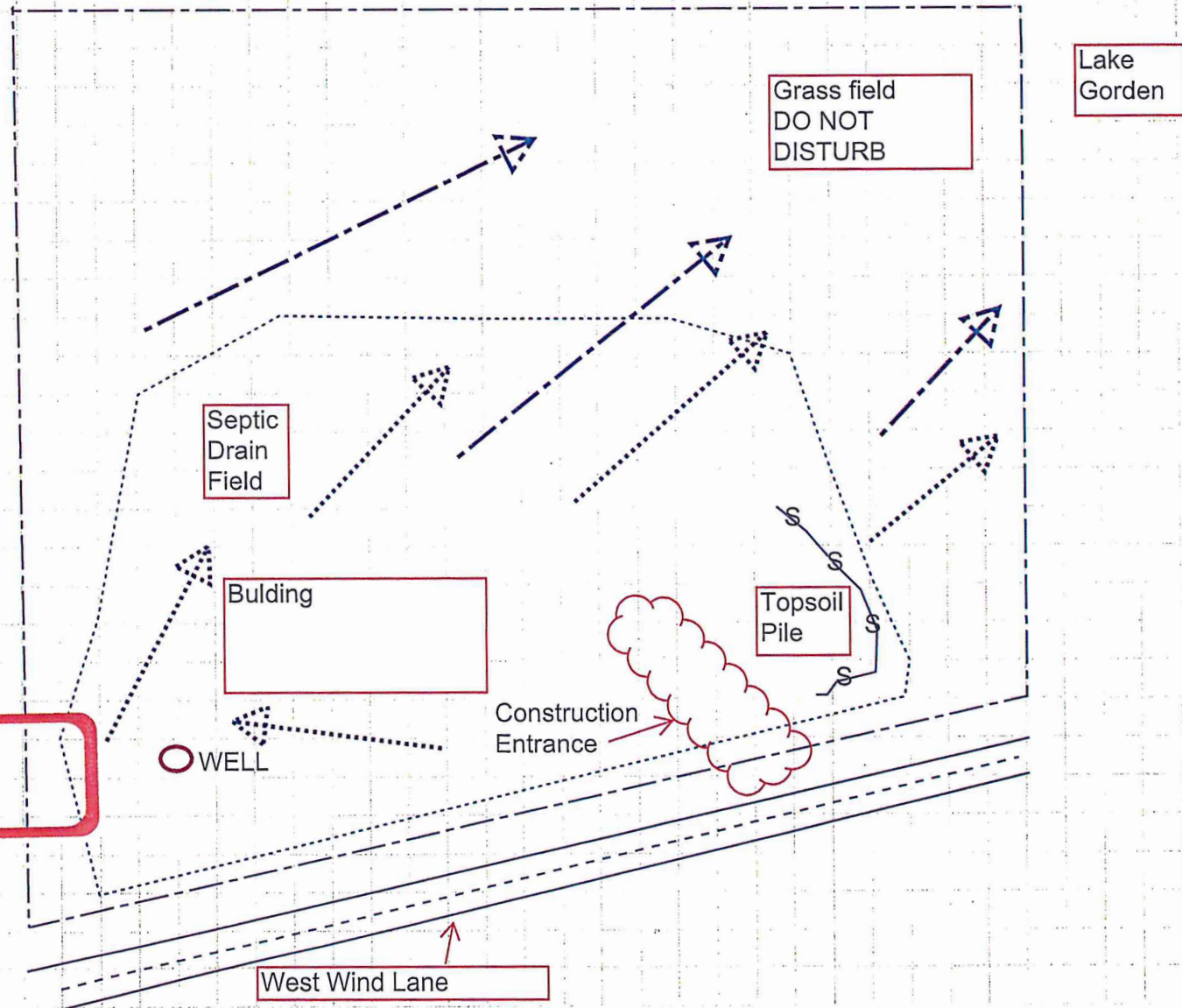

Address or location of Project: 1243 Wild West Lane City State Zip.

PLEASE INCLUDE THIS PAGE WITH SESC PLANS.

			✓ SITE PLAN CHCKLIST FOR SOIL EROSION PERMITS
Have	Need	N/A	
			Drawing must be to scale (map scale:1"=200' or less)
			Site location map showing nearest road intersection
			Legal description of property (i.e. T12N R4W Section 17 NW ¼, NE ¼.)
			Location and size of each proposed earth change (clearly defined ON DRAWING)
			Location and size of all temporary soil stockpiles
			Major geographic and vegetation features
			Location and size of all tree lines and forested areas
			Location and size of all existing buildings and structures
			Soil information (on drawing or in written form)
			Distance to nearest water body (lake, stream, river, county drain, wetland, etc.) for each proposed earth change.
			Location of all existing and proposed drainage and dewatering facilities
			Slope information or topography
			Location and detailed description of all TEMPORAY erosion and sedimentation control measures (shown on drawing)
			Location and detailed description of all PERMANENT erosion and sedimentation control measures (shown on drawing)
			Maintenance program for erosion and sedimentation control measures (including person responsible)
			Timing and sequence of construction (construction schedule)

TYPE OF EARTH CHANGE

- | | | |
|--|--|--|
| <input type="checkbox"/> single family residence (new construction) | <input type="checkbox"/> commercial/industrial (new) | <input type="checkbox"/> road |
| <input type="checkbox"/> single family residence (addition/alteration) | <input type="checkbox"/> commercial/industrial (add./alt.) | <input type="checkbox"/> pipeline |
| <input type="checkbox"/> garage (addition or detached) | <input type="checkbox"/> residential development (subdivision, multi-family) | <input type="checkbox"/> utility |
| <input type="checkbox"/> pole barn | <input type="checkbox"/> recreation development | <input type="checkbox"/> school/church |
| <input type="checkbox"/> pool (in ground) | <input type="checkbox"/> golf course | <input type="checkbox"/> hospital |
| <input type="checkbox"/> pond | | <input type="checkbox"/> other_____ |

ADDITIONAL EARTH CHANGE INFORMATION

- | | | |
|--|------------------------------|---|
| Has earth-moving activity started? | Yes <input type="checkbox"/> | No <input type="checkbox"/> |
| Is the earth-moving activity over 1 acre? | Yes <input type="checkbox"/> | No <input type="checkbox"/> |
| Will the work be occurring in a wetland? | Yes <input type="checkbox"/> | No <input type="checkbox"/> if yes, contact MDEQ |
| Will de-watering occur? | Yes <input type="checkbox"/> | No <input type="checkbox"/> |
| Will work be occurring in a waterway/floodplain? | Yes <input type="checkbox"/> | No <input type="checkbox"/> if yes, contact MDEQ |
| Will a designated county drain be affected? | Yes <input type="checkbox"/> | No <input type="checkbox"/> if yes, contact Gratiot County Drain Office |
| Will fill be brought on site? | Yes <input type="checkbox"/> | No <input type="checkbox"/> Amount in cubic yards_____ |
| Will material be removed from site? | Yes <input type="checkbox"/> | No <input type="checkbox"/> Amount in cubic yards_____ |

CITY OF ST. LOUIS
SOIL EROSION AND SEDIMENTATION CONTROL PERMIT
(Issued under the authority of Part 91, Soil Erosion and Sedimentation Control, of the Natural Resources and Environmental Protection Act, 1994 PA 451, as amended)

Permittee: _____

Address: _____

Permit No.: _____

Issued: _____

Expires: _____

Extended: _____

On-Site Contractor/Responsible Person: Name: _____

Company: _____ Telephone Number: (____) _____

Permitted Activity:

Project Location: Town _____ Range _____ Section _____

City of Township: _____

Address: _____

Permit Conditions:

1. The permitted activity shall be completed in accordance with the approved plans and specifications, and the **attached** general and specific conditions.
2. This permit does not waive the necessity for obtaining all other required federal, state, or local permits.
3. Permittee shall notify the permitting agency within one week after completing the permitted activity or one week prior to the permit expiration date, whichever comes first.

Permitting Agent (____) _____
Telephone Number

THIS PERMIT MUST BE POSTED AT THE PROJECT SITE

Permit Number: _____

GENERAL CONDITIONS:

In accordance with Rule 1709 promulgated under the authority of Part 91, Soil Erosion and Sedimentation Control, of the Natural Resources and Environmental Protection Act, 1994 PA 451, as amended, and in addition to the information on the attached plan(s) and special conditions, the following general conditions apply to the earth change authorized by this permit:

Design, construct, and complete the earth change in a manner that limits the exposed area of disturbed land for the shortest period of time.

Remove sediment caused by accelerated soil erosion from runoff water before it leaves the site of the earth change.

Temporary or permanent control measures shall be designed and installed to convey water around, through, or from the earth change at a non-erosive velocity.

Install temporary soil erosion and sedimentation control measures before or upon commencement of the earth change activity and maintain the measures on a daily basis. Remove temporary soil erosion and sedimentation control measures after permanent soil erosion measures are in place and the area is stabilized. ("Stabilized" means the establishment of vegetation or the proper placements, grading, or covering of soil to ensure its resistance to soil erosion, sliding, or other earth movement.)

Complete permanent soil erosion control measures for the earth change within five calendar days after final grading or upon completion of the final earth change. If it is not possible to permanently stabilize the earth change, then maintain temporary soil erosion and sedimentation control measures until permanent soil erosion control measures are in place and the area is stabilized.

SPECIFIC CONDITIONS
